

# Simplex sprocket for SER-SIT® taper bushing

for chain according to DIN 8187 - ISO/R 606



## ISO 08B-1 Pitch 1/2" x 5/16"

SPROCKET	[mm]
Tooth radius $r_3$	13
Radius width C	1,3
Tooth width $B_1$	7,2
CHAIN	[mm]
Pitch	12,7
Internal width	7,75
Roller $\phi$	8,51

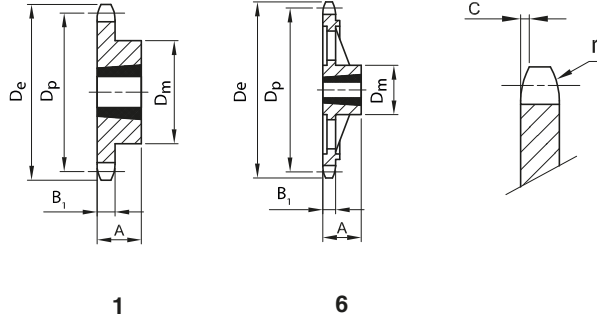

Z	De [mm]	Dp [mm]	Dm [mm]	A [mm]	SER-SIT® taper bushing	Fig.	W [kg]	Part Number
15	65,9	61,09	45	22	1008	1	0,16	QPBS08B1-015
16	69,9	65,10	50	22	1108	1	0,20	QPBS08B1-016
17	74,0	69,11	60	25	1210	1	0,22	QPBS08B1-017
18	78,0	73,14	60	25	1210	1	0,27	QPBS08B1-018
19	82,0	77,16	63	25	1210	1	0,33	QPBS08B1-019
20	86,0	81,19	67	25	1610	1	0,27	QPBS08B1-020
21	90,1	85,22	71	25	1610	1	0,36	QPBS08B1-021
22	94,1	89,24	71	25	1610	1	0,36	QPBS08B1-022
23	98,1	93,27	76	25	1610	1	0,50	QPBS08B1-023
24	102,1	97,29	76	25	1610	1	0,53	QPBS08B1-024
25	106,2	101,33	76	25	1610	1	0,56	QPBS08B1-025
26	110,2	105,36	76	25	1610	1	0,60	QPBS08B1-026
27	114,2	109,40	76	25	1610	1	0,63	QPBS08B1-027
28	118,3	113,42	90	32	2012	1	0,77	QPBS08B1-028
30	126,3	121,50	90	32	2012	1	0,91	QPBS08B1-030
38	158,6	153,80	90	32	2012	1	1,25	QPBS08B1-038
45	188,6	182,07	111	32	2012	1	1,68	QPBS08B1-045
57*	237,1	230,54	111	32	2012	6	2,78	QPBS08B1-057
76*	313,9	307,33	111	32	2012	6	3,81	QPBS08B1-076

Material	Steel C45
	*Cast Iron EN-GJL-200
De	External diameter
Dp	Pitch diameter
Dm	Hub diameter
W	Weight

# Duplex sprocket for SER-SIT® taper bushing

for chain according to DIN 8187 - ISO/R 606



## ISO 08B-2 Pitch 1/2" x 5/16"

SPROCKET	[mm]
Tooth radius $r_3$	13
Radius width C	1,3
Tooth width $b_1$	7
Tooth width $B_2$	21
CHAIN	[mm]
Pitch	12,7
Internal width	7,75
Roller $\phi$	8,51

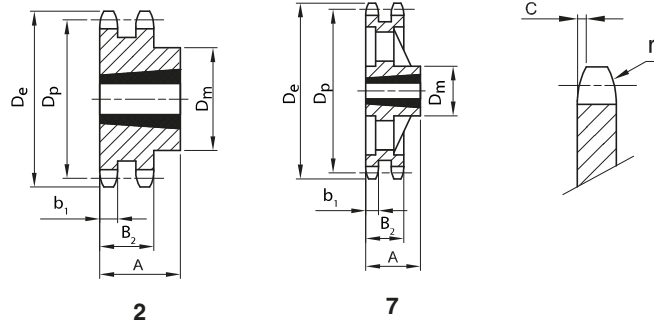

Z	$D_e$ [mm]	$D_p$ [mm]	$D_m$ [mm]	A [mm]	SER-SIT® taper bushing	Fig.	W [kg]	Part Number
15	65,9	61,09	46	22	1008	2	0,22	QPBD08B2-015
16	69,9	65,10	50	22	1108	2	0,22	QPBD08B2-016
17	74,0	69,11	56	25	1210	2	0,23	QPBD08B2-017
18	78,0	73,14	60	25	1210	2	0,30	QPBD08B2-018
19	82,0	77,16	62	25	1210	2	0,38	QPBD08B2-019
20	86,0	81,19	66	25	1610	2	0,45	QPBD08B2-020
21	90,1	85,22	70	25	1610	2	0,50	QPBD08B2-021
22	94,1	89,24	76	25	1610	2	0,55	QPBD08B2-022
23	98,1	93,27	79	25	1610	2	0,62	QPBD08B2-023
24	102,1	97,29	84	32	2012	2	0,68	QPBD08B2-024
25	106,2	101,33	87	32	2012	2	0,72	QPBD08B2-025
26	110,2	105,36	87	32	2012	2	0,82	QPBD08B2-026
27	114,2	109,40	87	32	2012	2	0,92	QPBD08B2-027
28	118,3	113,42	87	32	2012	2	1,10	QPBD08B2-028
30	126,3	121,50	87	32	2012	2	1,24	QPBD08B2-030
38	158,6	153,80	100	32	2012	2	2,50	QPBD08B2-038
57*	237,1	230,54	111	32	2012	7	3,64	QPBD08B2-057
76*	313,9	307,33	111	32	2012	7	5,09	QPBD08B2-076

ISO duplex sprockets for bushing

Material	Steel C45 *Cast Iron EN-GJL-200
$D_e$	External diameter
$D_p$	Pitch diameter
$D_m$	Hub diameter
W	Weight

# Triplex sprocket for SER-SIT® taper bushing

for chain according to DIN 8187 - ISO/R 606



## ISO 08B-3 Pitch 1/2" x 5/16"

SPROCKET	[mm]
Tooth radius $r_3$	13
Radius width C	1,3
Tooth width $b_1$	7
Tooth width $B_3$	34,9
CHAIN	[mm]
Pitch	12,7
Internal width	7,75
Roller $\varnothing$	8,51

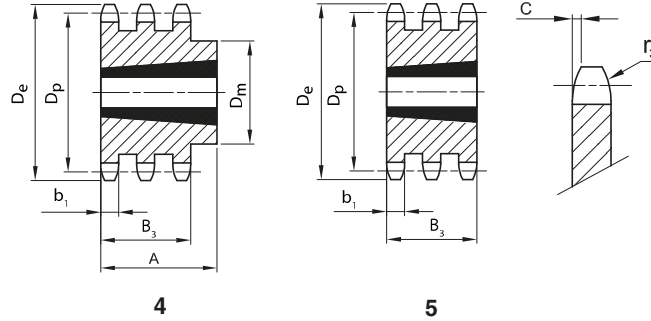

Z	$D_e$ [mm]	$D_p$ [mm]	$D_m$ [mm]	A [mm]	SER-SIT® taper bushing	Fig.	W [kg]	Part Number
15	65,9	61,09	-	34,9	1008	5	0,36	QPBT08B3-015
17	74,0	69,11	-	34,9	1210	5	0,35	QPBT08B3-017
19	82,0	77,16	62	38,0	1215	4	0,61	QPBT08B3-019
21	90,1	85,22	70	38,0	1615	4	0,65	QPBT08B3-021
23	98,1	93,27	70	38,0	1615	4	0,93	QPBT08B3-023
25	106,2	101,33	-	34,9	2012	5	0,85	QPBT08B3-025
27	114,2	109,40	-	34,9	2012	5	1,18	QPBT08B3-027
30	126,3	121,50	-	34,9	2012	5	1,73	QPBT08B3-030
38	158,6	153,80	-	34,9	2012	5	3,53	QPBT08B3-038

Material	Steel C45
$D_e$	External diameter
$D_p$	Pitch diameter
$D_m$	Hub diameter
W	Weight

# Simplex sprocket for SER-SIT® taper bushes hardened teeth

for chain according to DIN 8187 - ISO/R 606



## ISO 08B-1 Pitch 1/2" x 5/16"

SPROCKET	[mm]
Tooth radius $r_3$	13
Radius width C	1,3
Tooth width $B_1$	7,2
CHAIN	[mm]
Pitch	12,7
Internal width	7,75
Roller $\varnothing$	8,51

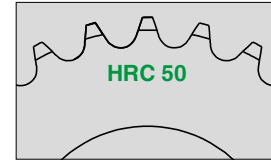
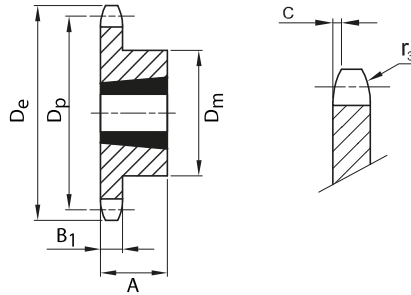

Z	$D_e$ [mm]	$D_p$ [mm]	$D_m$ [mm]	A [mm]	SER-SIT® taper bushing	W [kg]	Part Number
15	65,9	61,09	45	22	1008	0,16	QPBHS08B1-015
17	74,0	69,11	60	25	1210	0,22	QPBHS08B1-017
19	82,0	77,16	63	25	1210	0,33	QPBHS08B1-019
21	90,1	85,22	71	25	1610	0,36	QPBHS08B1-021
23	98,9	93,27	76	25	1610	0,50	QPBHS08B1-023
25	106,7	101,32	76	25	1610	0,56	QPBHS08B1-025
27	114,8	109,39	76	25	1610	0,63	QPBHS08B1-027
30	126,9	121,49	90	32	2012	0,91	QPBHS08B1-030

Material	Steel C45
$D_e$	External diameter
$D_p$	Pitch diameter
$D_m$	Hub diameter
W	Weight