



This JOHN KING Din series chain is a specific German standard as BS is British. This series is comparable to M and in some sizes identical. The range is not as extensive in terms of higher strengths, but again is available in bush, standard and large roller together with flanged roller. This series is encountered across the whole spectrum of industry but notably in timber products and construction machinery. The Din standard establishes very specific parameters for materials, and construction.



Type A - Bush type



Type B - Small roller



Type C - Large roller



Type D - Flange roller

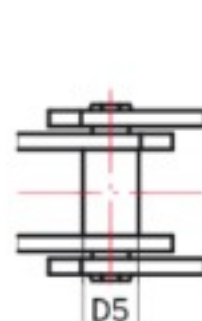
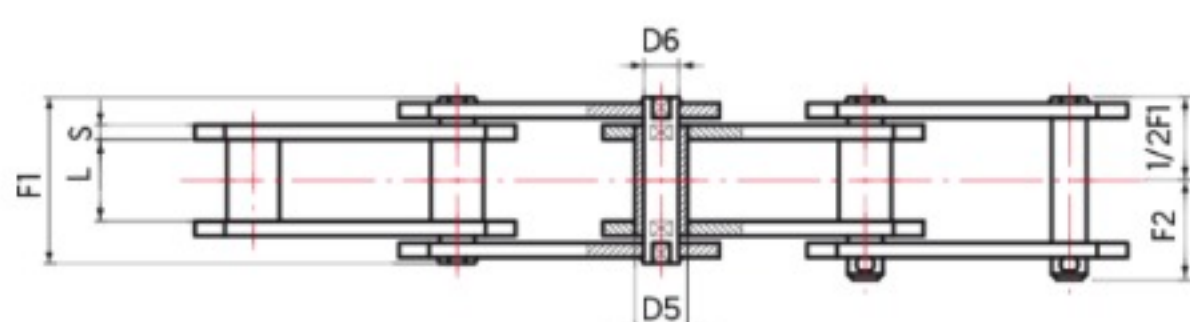
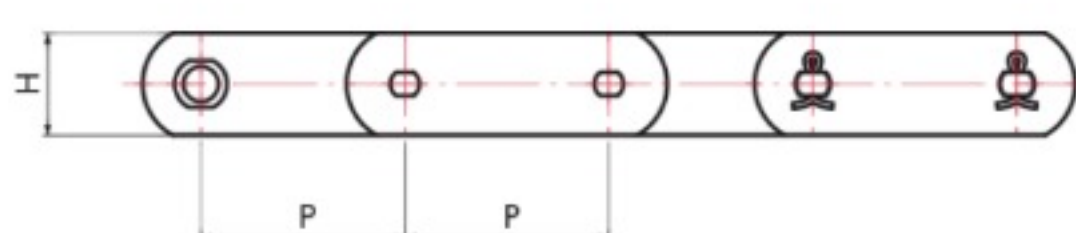

Type A

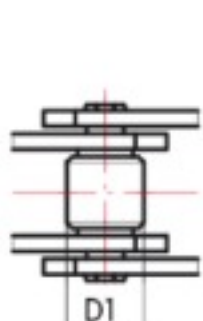

Type B

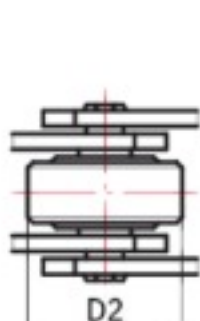

Type C

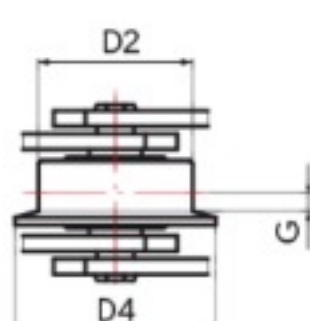

Type D

FV Series Metric Conveyor Chains DIN 8165

Chain Number	Pitch	Rollers					Bushings	Pins	Over-All Pin & Cotter		Between Sidebars	Sidebars		Breaking Load		
		Style		Flange Thickness	Diameter		D5	D6	F1	F2	L	Thickness	Height	DIN standard	John King*	
		D1	D2	D3	D4	G						S	H			
		P	mm													
FV40	50	20	32	40	50	4	15	10	36	21	18	3	25	42	47	
FV40	63	20	32	40	50	4	15	10	36	21	18	3	25	42	47	
FV40	80	20	32	40	50	4	15	10	36	21	18	3	25	42	47	
FV40	100	20	32	40	50	4	15	10	36	21	18	3	25	42	47	
FV40	125	20	32	40	50	4	15	12	36	21	18	3	25	42	47	
FV63	63	26	40	50	63	5	18	12	45	26	22	4	30	64	75	
FV63	80	26	40	50	63	5	18	12	45	26	22	4	30	64	75	
FV63	100	26	40	50	63	5	18	12	45	26	22	4	30	64	75	
FV63	125	26	40	50	63	5	18	12	45	26	22	4	30	64	75	
FV63	160	26	40	50	63	5	18	12	45	26	22	4	30	64	75	
FV90	63	30	48	63	78	6.5	20	14	53	30	25	5	35	100	115	
FV90	80	30	48	63	78	6.5	20	14	53	30	25	5	35	100	115	
FV90	100	30	48	63	78	6.5	20	14	53	30	25	5	35	100	115	
FV90	125	30	48	63	78	6.5	20	14	53	30	25	5	35	100	115	
FV90	160	30	48	63	78	6.5	20	14	53	30	25	5	35	100	115	
FV90	200	30	48	63	78	6.5	20	14	53	30	25	5	35	100	115	
FV90	250	30	48	63	78	6.5	20	14	53	30	25	5	35	100	115	
FV112	100	32	55	72	90	7.5	22	16	62	35	30	6	40	120	170	
FV112	125	32	55	72	90	7.5	22	16	62	35	30	6	40	120	170	
FV112	160	32	55	72	90	7.5	22	16	62	35	30	6	40	120	170	
FV112	200	32	55	72	90	7.5	22	16	62	35	30	6	40	120	170	
FV112	250	32	55	72	90	7.5	22	16	62	35	30	6	40	120	170	
FV140	100	36	60	80	100	9	26	18	67	41	35	6	45	145	180	
FV140	125	36	60	80	100	9	26	18	67	41	35	6	45	145	180	
FV140	160	36	60	80	100	9	26	18	67	41	35	6	45	145	180	
FV140	200	36	60	80	100	9	26	18	67	41	35	6	45	145	180	
FV140	250	36	60	80	100	9	26	18	67	41	35	6	45	145	180	
FV180	125	42	70	100	125	13	30	20	86	51	45	8	50	190	250	
FV180	160	42	70	100	125	13	30	20	86	51	45	8	50	190	250	
FV180	200	42	70	100	125	13	30	20	86	51	45	8	50	190	250	
FV180	250	42	70	100	125	13	30	20	86	51	45	8	50	190	250	
FV180	315	42	70	100	125	13	30	20	86	51	45	8	50	190	250	
FV250	160	50	80	125	150	15	36	26	97	56	55	8	60	275	300	
FV250	200	50	80	125	150	15	36	26	97	56	55	8	60	275	300	
FV250	250	50	80	125	150	15	36	26	97	56	55	8	60	275	300	
FV250	315	50	80	125	150	15	36	26	97	56	55	8	60	275	300	
FV315	160	60	90	140	175	18	42	30	116	66	65	10	70	370	480	
FV315	200	60	90	140	175	18	42	30	116	66	65	10	70	370	480	
FV315	250	60	90	140	175	18	42	30	116	66	65	10	70	370	480	
FV315	315	60	90	140	175	18	42	30	116	66	65	10	70	370	480	
FV315	400	60	90	140	175	18	42	30	116	66	65	10	70	370	480	
FV400	160	60	100	150	185	20	44	32	132	76	70	12	70	400	640	
FV400	200	60	100	150	185	20	44	32	132	76	70	12	70	400	640	
FV400	250	60	100	150	185	20	44	32	132	76	70	12	70	400	640	
FV400	315	60	100	150	185	20	44	32	132	76	70	12	70	400	640	
FV400	400	60	100	150	185	20	44	32	132	76	70	12	70	400	640	
FV500	160	70	110	160	195	21	50	36	142	81	80	12	80	500	750	
FV500	200	70	110	160	195	21	50	36	142	81	80	12	80	500	750	
FV500	250	70	110	160	195	21	50	36	142	81	80	12	80	500	750	
FV500	315	70	110	160	195	21	50	36	142	81	80	12	80	500	750	
FV500	400	70	110	160	195	21	50	36	142	81	80	12	80	500	750	
FV500	500	70	110	160	195	21	50	36	142	81	80	12	80	500	750	

* Breaking Load With heat treated Plates

FV40 - FV180 chains: Pressed bush with welded or riveted pin

FV250 - FV500 chains: Welded or pressed bush with welded or riveted pin



Pressed bush, welded pin



Welded bush, welded pin



Pressed bush, riveted pin

Special attention should be applied to options in construction.